



REPTI SUN

5.0 UVB TROPICAL

INSTRUCTIONS

Congratulations on your purchase of **Zoo Med's ReptiSun 5.0 UVB Compact Fluorescent Lamp**; your reptiles will thank you! The following instructions will assist you in determining the correct set-up for your specific application.

LAMP FIXTURES AND APPLICATIONS:

This lamp will screw into a standard screw-base lamp fixture. The type of fixture you use will determine the correct distance of the lamp to your reptile's basking site. Use the following descriptions and the chart below to determine the correct set up for your reptile.

- **Lamp used in an aluminum clamp lamp fixture:** Some clamp lamp fixtures have an aluminum dome-shaped reflector (figure 1) which reflects UVB and increases the distance that UVB will penetrate in your terrarium. **Zoo Med's Economy Clamp Lamp™ (Item # LF-5)** and **Zoo Med's Deep Dome Lamp Fixture (Item # LF-17)** are examples of this type of fixture.
- **Lamp used in a clamp lamp fixture with a white finish inside the reflector, or with no reflector:** Certain clamp lamp fixtures have a dome-shaped reflector that is painted white on the inside (figure 2). Since the white surface does not reflect UVB, lamps used in these fixtures will need to be placed closer to the reptile's basking site. **Zoo Med's Deluxe Porcelain Clamp Lamps (Item #'s LF-11, LF-12, and LF-15)** are examples of this type of fixture.
- **Lamp positioned horizontally over a terrarium:** While clamp lamp fixtures result in the lamp being positioned vertically over the terrarium, some hoods allow for the lamp to be positioned horizontally over the terrarium (figure 3). The UVB output is greatly increased when the lamp is positioned horizontally over the terrarium.

NOTES ON SCREEN COVERS:

Screen covers on terrariums significantly reduce the amount of UVB that reaches your reptile's basking site. As the screen mesh gets finer, more UVB is blocked or filtered. Some reptile habitats do not require the use of screen covers. Examples include aquatic turtle tanks, and tortoise habitats.

NOTES ON LAMP BURN-IN:

Compact fluorescent lamps have a "burn-in" period when the UVB output is the greatest. For your new **ReptiSun 5.0 Compact Fluorescent Lamp**, this period lasts about two weeks (150 hours of use). After the burn-in period is over, you may want to move your lamp closer to the basking site. Refer to the following chart for recommended distances during and after the burn-in period. A **Zoo Med Reptile Lamp Stand** (figure 4) will allow you to easily adjust the distance of the lamp to the basking site.

**please email or phone us with any questions you may have.
email: zoomed@zoomed.com*

APPLICATION CHART:

LAMP ARRANGEMENT/ TERRARIUM SETUP	DURING/ AFTER BURN-IN	RECOMMENDED OPERATING DISTANCE*
-Aluminum clamp lamp fixture -Terrarium <i>with</i> screen cover	During burn-in	11-13" (28-33cm)
	After burn-in	9-11" (23-28cm)
-Aluminum clamp lamp fixture -Terrarium <i>without</i> screen cover	During burn-in	15-17" (38-43cm)
	After burn-in	12-14" (30-36cm)
-Clamp lamp with white finish inside reflector -Terrarium <i>with</i> screen cover	During burn-in	7-9" (18-23cm)
	After burn-in	4-6" (10-15cm)
-Clamp lamp with white finish inside reflector -Terrarium <i>without</i> screen cover	During burn-in	9-11" (23-28cm)
	After burn-in	6-8" (15-20cm)
-Lamp positioned horizontally over terrarium -Terrarium <i>with</i> screen cover	During burn-in	12-14" (30-36cm)
	After burn-in	8-10" (20-25cm)
-Lamp positioned horizontally over terrarium -Terrarium <i>without</i> screen cover	During burn-in	17-19" (43-48cm)
	After burn-in	11- 13" (28-33cm)

*NOTES ON OPERATING RANGE:

The operating range is the distance from the lamp to the reptile's basking site.

In order for your reptile to benefit from the UVB, you must provide your reptile with the appropriate temperature zone. Consult a good book to learn about the requirements of your species.

WHEN TO REPLACE YOUR LAMP:

Your lamp will provide beneficial UVB for a period of 6 months. After 6 months, the lamp should be replaced with a new **ReptiSun 5.0 UVB Compact Fluorescent Lamp**. Before you turn your lamp on for the first time, date the base of the lamp to remind yourself when to replace it.

DIGITAL UVB METERS:

If you are interested in measuring the amount of UVB that your lamp is producing, you may want to purchase **Zoo Med's Digital UVB Radiometer (Item # ST-6)**. This meter is available in the "store" section at www.zoomed.com, or by special order through your reptile product retailer.

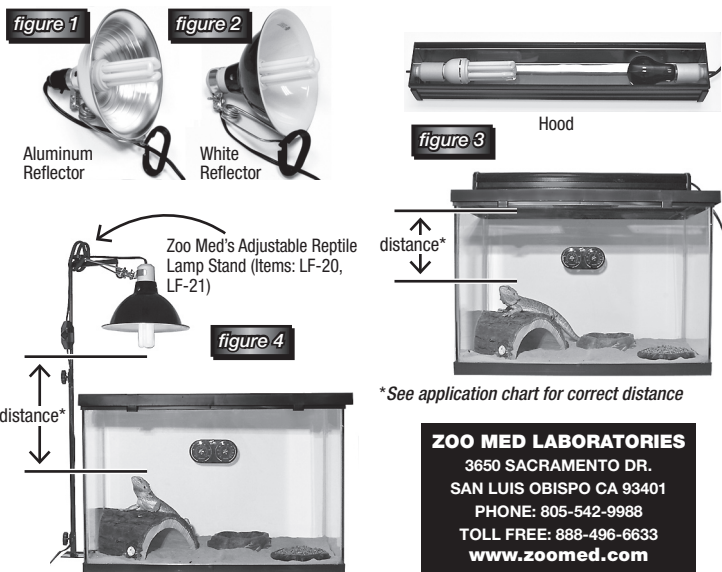

ZOO MED LABORATORIES
3650 SACRAMENTO DR.
SAN LUIS OBISPO CA 93401
PHONE: 805-542-9988
TOLL FREE: 888-496-6633
www.zoomed.com